

The use of this data by the recipient acts as an agreement of the following statements. Do not use this data if you do not agree with any of the following statements:

All drawings are based upon site information supplied by third parties and as such their accuracy cannot be guaranteed. All features are approximate and subject to clarification by a detailed topographical survey, statutory service enquiries and confirmation of the legal boundaries.

The controlled version of this drawing should be viewed in DWG or PDF format not DWG or other formats. All prints of this drawing must be made in full colour.

Where this drawing has been based upon Ordnance Survey data, it has been reproduced under the terms of Ryder Licence No. 100000144. Reproduction of this drawing in whole or in part is prohibited without the prior permission of Ordnance Survey.

Do not scale the drawing. Use figured dimensions in all cases. Check all dimensions on site. Report any discrepancies in writing to Ryder before proceeding.

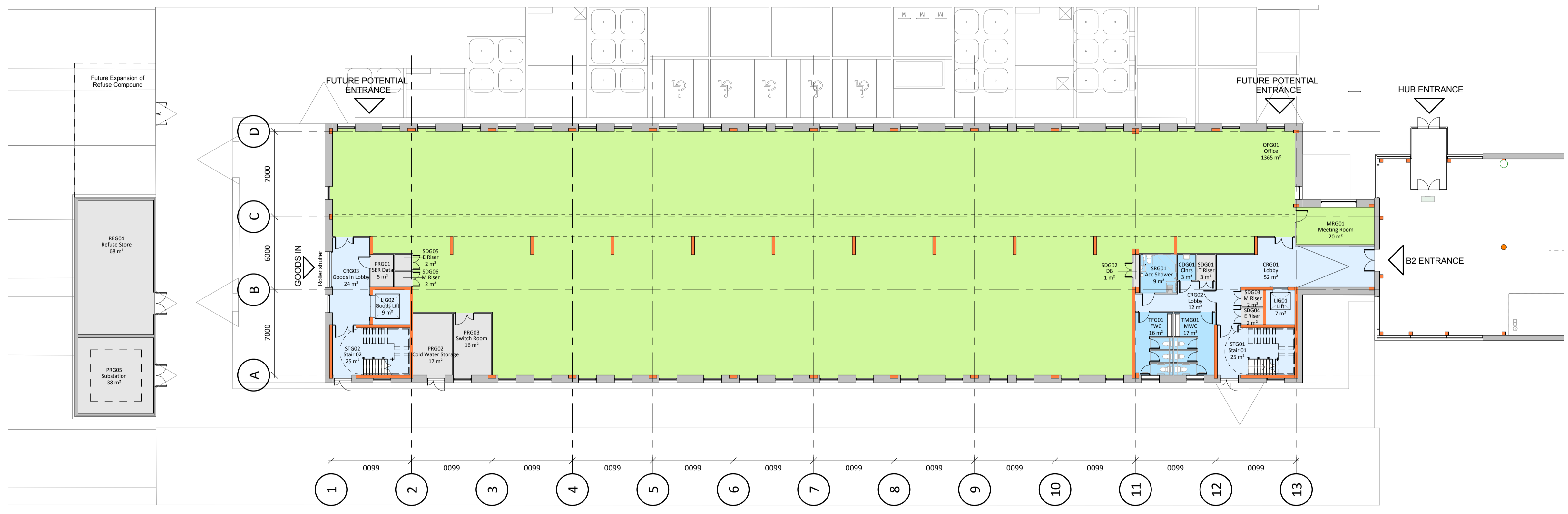
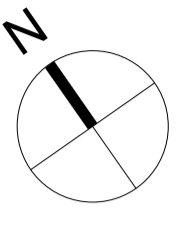

Revision	Date	Drawn by	Checked by
P4	28/09/17	AAI	PSw
Updated in line with VE redesign			
P3	16/08/17	AAI	PSw
Room names updated in line with University protocols			
P2	27/07/17	AAI	PSw
Amended in line with Client comments, 26/07/17.			
P1	24/07/17	AAI	PSw
First Issue			

Amendment:
 Purpose of Issue:
Preliminary
 Project:
University of Reading
Thames Valley Science Park - Building 02
Reading
 Drawing:
Proposed Ground Floor GA Plan

Drawing No.	Project ID	Originator	Zone	Level	Type	Role	Number
TVSPB2	-	RYD	- 00	- 00	- DR	- A	- 3000
Ryder Project No.	Scale at A1	Drawn By	Status	Revision			
2814-02	1 : 200	AAI	S1	P4			

The use of this data by the recipient acts as an agreement of the following statements. Do not use this data if you do not agree with any of the following statements:

All drawings are based upon site information supplied by third parties and as such their accuracy cannot be guaranteed. All features are approximate and subject to clarification by a detailed topographical survey, statutory service enquiries and confirmation of the legal boundaries.

The controlled version of this drawing should be viewed in DWG or PDF format not DWG or other formats. All prints of this drawing must be made in full colour.

Where this drawing has been based upon Ordnance Survey data, it has been reproduced under the terms of Ryder Licence No. 100000144. Reproduction of this drawing in whole or in part is prohibited without the prior permission of Ordnance Survey.

Do not scale the drawing. Use figured dimensions in all cases. Check all dimensions on site. Report any discrepancies in writing to Ryder before proceeding.

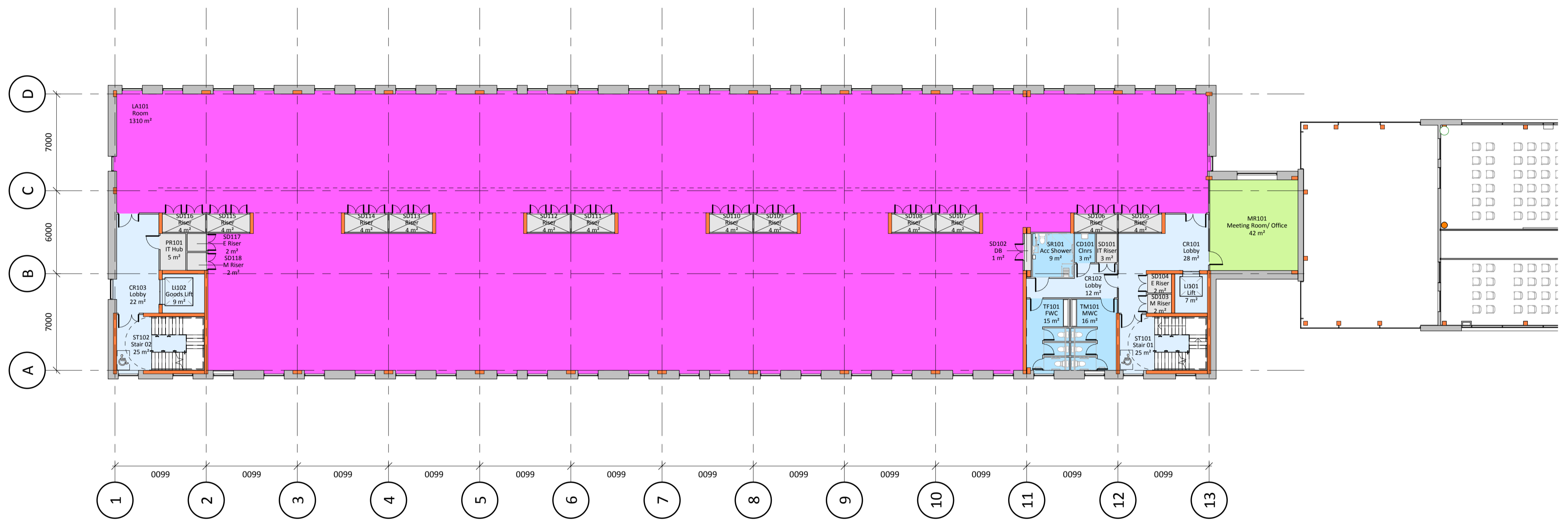
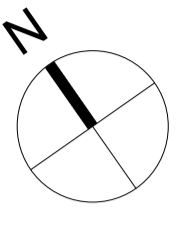

Revision	Date	Drawn by	Checked by
P4	28/09/17	AAI	PSw
Updated in line with VE redesign			
P3	16/08/17	AAI	PSw
Room names updated in line with University protocols			
P2	27/07/17	AAI	PSw
Amended in line with Client comments, 16/07/17.			
P1	24/07/17	AAI	PSw
First Issue			

Amendment:
 Purpose of Issue:
Preliminary
 Project:
University of Reading
Thames Valley Science Park - Building 02
Reading
 Drawing:
Proposed First Floor GA Plan

Drawing No.	Project ID	Originator	Zone	Level	Type	Role	Number
TVSPB2	-	RYD	-00	-01	-DR	-A	-3001
Ryder Project No.	Scale at A1	Drawn By	Status	Revision			
2814-02	1 : 200	AAI	S1	P4			

The use of this data by the recipient acts as an agreement of the following statements. Do not use this data if you do not agree with any of the following statements:

All drawings are based upon site information supplied by third parties and as such their accuracy cannot be guaranteed. All features are approximate and subject to clarification by a detailed topographical survey, statutory service enquiries and confirmation of the legal boundaries.

The controlled version of this drawing should be viewed in DWG or PDF format not DWG or other formats. All prints of this drawing must be made in full colour.

Where this drawing has been based upon Ordnance Survey data, it has been reproduced under the terms of Ryder Licence No. 100000144. Reproduction of this drawing in whole or in part is prohibited without the prior permission of Ordnance Survey.

Do not scale the drawing. Use figured dimensions in all cases. Check all dimensions on site. Report any discrepancies in writing to Ryder before proceeding.

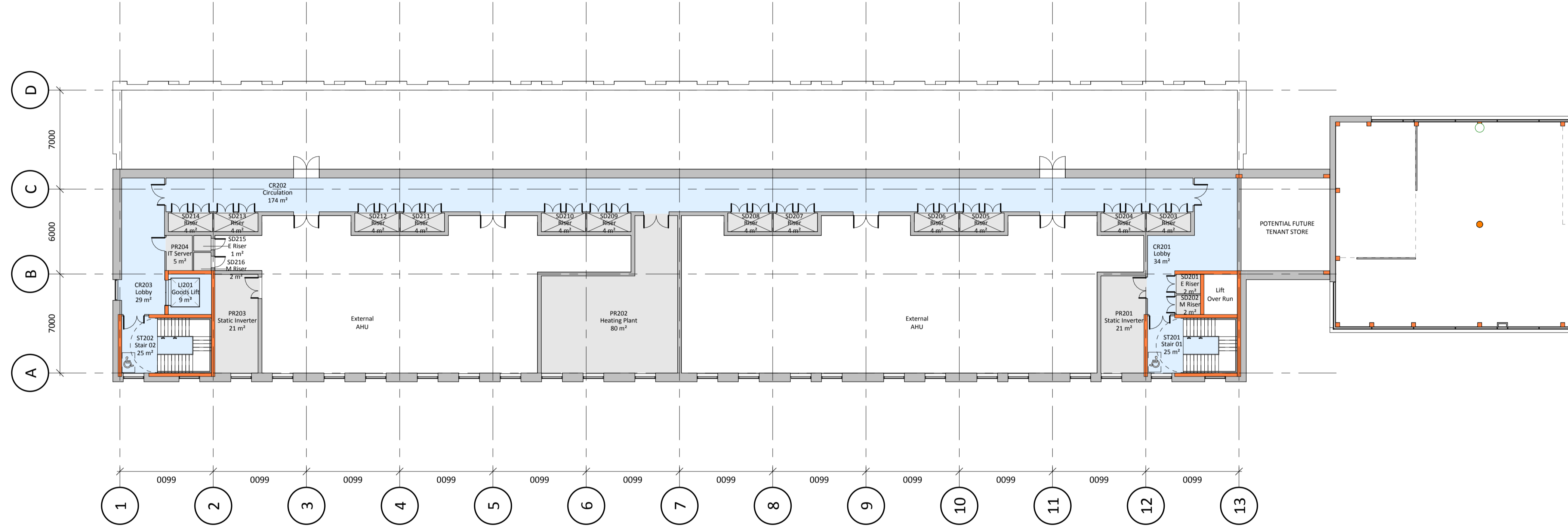
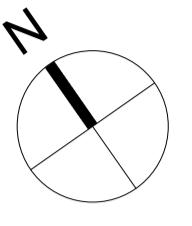

Revision	Date	Drawn by	Checked by
P4	28/09/17	AAI	PSW
Updated in line with VE redesign			
P3	16/08/17	AAI	PSW
Room names updated in line with University protocols			
P2	27/07/17	AAI	PSW
Amended in line with Client comments, 16/07/17.			
P1	24/07/17	AAI	PSW
First Issue			

Amendment:
 Purpose of Issue:
Preliminary
 Project:
University of Reading
Thames Valley Science Park - Building 02
Reading
 Drawing:
Proposed Second Floor Roof GA Plan

Drawing No.	Originator	Zone	Level	Type	Role	Number
TVSPB2	RYD	- 00 - 02 - DR - A	- 3002			
Ryder Project No.	Scale at A1	Drawn By	Status	Revision		
2814-02	1 : 200	AAI	S1	P4		